

# STRAUB-FLEX / STRAUB-OPEN-FLEX 4 Ø 323.9 - 4064.0 mm

Components / Materials	W1	W2	W4	W5
Casing	AISI A106 , hot-dip galv.			S32101 (LDX)
Bolts	AISI 4135			A4 - 80
Bars	AISI 12 L 14, galvanised			AISI 316 L
Strip insert	AISI 301 / HDPE			AISI 301 / HDPE

**Sealing sleeve EPDM**  
 Temp.: -20°C up to +100°C  
 Medium: all qualities of water, waste water, air, solids and chemical products

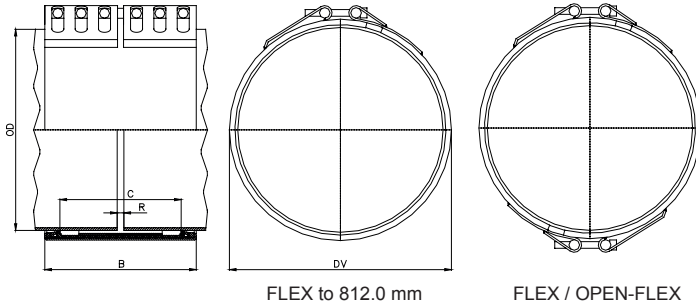

- B Width of pipe coupling:  
 FLEX / OPEN-FLEX 4 LV = 443 mm  
 FLEX / OPEN-FLEX 4 H = 444 mm
- DV Outside diameter of the coupling installed = OD+48 mm
- C Distance between sealing lips = 350 mm
- R<sub>max.</sub> Distance between pipe ends with strip insert = 200 mm  
 Distance between pipe ends without strip insert = 20 mm

Pipe OD [mm]	Clamping range [mm]	Working pressure PS [bar]		Torque rate [Nm]	
		LV (LDX)	H	LV (LDX)	H
<b>323.9<sup>5</sup></b>	<b>320 - 327</b>	<b>25.0</b>	<b>25.0</b>	<b>40</b>	<b>40</b>
<b>355.6<sup>5</sup></b>	<b>352 - 359</b>	<b>25.0</b>	<b>25.0</b>	<b>40</b>	<b>40</b>
<b>406.4<sup>5</sup></b>	<b>403 - 409</b>	<b>25.0</b>	<b>25.0</b>	<b>40</b>	<b>40</b>
<b>457.2<sup>5</sup></b>	<b>454 - 460</b>	<b>24.0</b>	<b>25.0</b>	<b>40</b>	<b>40</b>
<b>508.0<sup>5</sup></b>	<b>505 - 512</b>	<b>22.0</b>	<b>23.0</b>	<b>40</b>	<b>40</b>
<b>558.8<sup>5</sup></b>	<b>555 - 562</b>	<b>20.0</b>	<b>21.0</b>	<b>40</b>	<b>40</b>
<b>609.6<sup>5</sup></b>	<b>606 - 613</b>	<b>19.0</b>	<b>19.0</b>	<b>40</b>	<b>40</b>
655.0 <sup>5</sup>	652 - 658	18.0	18.0	40	40
711.2 <sup>5</sup>	707 - 715	16.0	17.0	40	40
762.0 <sup>5</sup>	758 - 766	15.0	16.0	40	40
812.8 <sup>5</sup>	809 - 817	14.0	14.0	50	50
914.4	910 - 918	12.0	13.0	50	50
1016.0	1012 - 1020	10.0	11.0	60	60
1117.6	1113 - 1122	10.0	10.0	60	60
1219.2	1215 - 1224	9.0	9.0	70	70
1422.4	1418 - 1427	7.0	8.0	70	70
1524.0	1519 - 1529	6.0	7.0	80	80
1625.0	1621 - 1631	6.0	7.0	80	80
1727.2	1722 - 1732	6.0	7.0	90	90
1828.8	1824 - 1834	5.0	6.0	100	100
1930.4	1925 - 1935	5.0	6.0	110	110
2032.0	2027 - 2037	4.0	5.0	120	120
2268.0	2263 - 2273	3.5	4.5	130	130
2540.0	2535 - 2545	3.0	4.0	140	140
2794.0	2798 - 2799	3.0	3.0	140	140
3048.0	3043 - 3053	2.0	3.0	160	160
3302.0	3296 - 3308	2.0 <sup>3</sup>	3.0 <sup>3</sup>	170	170
3556.0	3548 - 3562	1.5 <sup>3</sup>	2.5 <sup>3</sup>	180	180
3810.0	3804 - 3816	1.0 <sup>3</sup>	2.0 <sup>3</sup>	190	190
4064.0	4058 - 4070	1.0 <sup>3</sup>	2.0 <sup>3</sup>	210	210

**STRAUB produces custom made couplings from 323.9 up to 4064.0 mm**

**Remarks:**

- Follow fitting / disassembly instructions
- PS = Working pressure considering the application loads  
 Test pressure = PS x 1.5 (for example industry, water supply etc.)  
 Burst pressure = approx. PS x 2
- Strip inserts are required for special applications (included)
- LV(LDX)-version in W5
- H-version in W1

<sup>3</sup> Available in three-piece version only

<sup>5</sup> STRAUB-FLEX available in one-piece version as well

**For IPS sizes in bold see technical manual for actual OD**

*Typing errors may occur. Technical details are subject to change*